

**KITCHEN PRO**



# PREP HANDHELD ADJUSTABLE Mandoline Slicer

## IMPORTANT

Read and follow all warnings and instructions before assembly and use.  
Keep this manual for future reference.

# Specifications

---

- Model number: 722991
- Dimensions: 31.3x10x4cm
- Material: ABS, PP, TPE, stainless steel

## Product features

---

- Slices fruit and vegetables with ease and precision
- Four adjustable thickness settings
- Non-skid feet for more stable control
- Food guard for added safety
- Top rack dishwasher safe (food guard only)

## Safety precautions

---

- This mandoline slicer is designed for slicing fruits and vegetables for household kitchen use only. The blade is extremely sharp. Handle with care during unpacking, use and cleaning.
- Always use the food guard when slicing to prevent injury.
- Keep fingers and hands away from the blade at all times.
- Keep out of reach of children.
- Do not use the mandoline if any part is damaged.

## Get to know the Kitchen Pro Prep Handheld Adjustable Mandoline Slicer



### Product components

- |                    |                              |
|--------------------|------------------------------|
| 1. Food guard      | 4. Soft-grip handle          |
| 2. Slicer blade    | 5. Thickness adjustment dial |
| 3. Adjustable ramp | 6. Non-slip feet             |

## Before first use

---

- Carefully unpack all components.
- Wash all parts with warm soapy water.
- Dry thoroughly before assembly.
- Blades are extremely sharp. Handle with care.

# Operating instructions

---

## Step 1: Select slice thickness

Rotate the thickness adjustment dial and slide it to the desired setting.

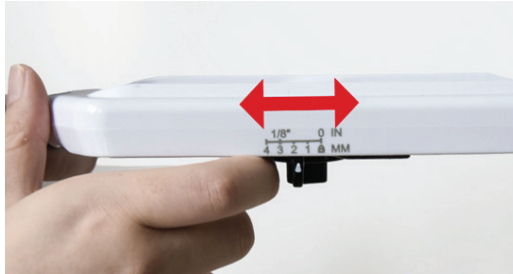

## Step 2: Secure the food

Insert the food item onto the pins of the food guard, ensuring it is firmly held.

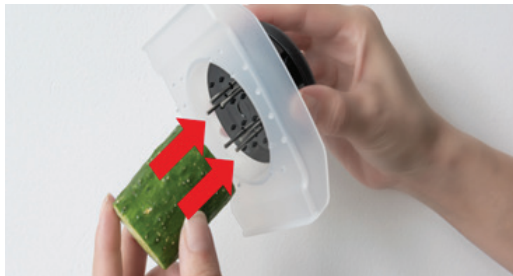

## Step 3: Slice

Hold the handle firmly and slide the food guard back and forth over the blade using smooth, even strokes.



Important: Always keep your hands behind the food guard during slicing.

# Slice thickness settings (straight slice)

---

Setting	Thickness
1	1mm
2	2mm
3	3mm
4	4mm

## Cleaning and storing

---

- Wash the mandoline slicer immediately after use under running water to prevent food buildup and maintain blade sharpness.
- Use caution when cleaning around the blade.
- Turn the thickness dial to the locked position before storing.
- The food guard is top rack dishwasher safe. Hand wash all other parts.

## **Get in touch with Customer Service**

If you experience any issues with your Kitchen Pro Prep Handheld Adjustable Mandoline Slicer, get in touch with our Customer Service team by email at [customerservice@kitchenwarehouse.com.au](mailto:customerservice@kitchenwarehouse.com.au) or by phone on 1800 332 934 between the hours of 9am and 7pm (AEST) Monday to Friday.

## **Warranty**

Our goods come with guarantees that cannot be excluded under the Australian Consumer Law. You are entitled to a replacement or refund for a major failure and for compensation for any other reasonably foreseeable loss or damage. You are also entitled to have the goods repaired or replaced if the goods fail to be of acceptable quality and the failure does not amount to a major failure.

The benefits of this warranty are in addition to any rights and remedies imposed by Australian State and Federal legislation that cannot be excluded. Nothing in this warranty excludes, restricts or modifies any State or Federal legislation applicable to the supply of goods which cannot be so excluded, restricted or modified.

## **Guarantee**

We warrant that, subject to the exclusions and limitations below, the Product will be free from defects in materials and workmanship under normal domestic household use for the five year warranty period. The warranty period commences on the date of sale by the original retailer to the original purchaser. The warranty applies only while the Product is owned by the original purchaser.

Use of the Product in a commercial capacity will void this warranty. If a defect appears in the Product before the end of the warranty period and we find the Product to be defective in materials or workmanship, we will replace the Product with a product comparable in quality and value.

We reserve the right to change or discontinue our product ranges at any time without notice and without liability.

## **Exclusions**

This warranty does not apply if proper care and/or usage instructions are not followed. This warranty does not cover scratches, stains, discoloration or damage caused by misuse.

## **How to claim**

If a fault/defect is identified cease using the Product immediately. To make a claim on this guarantee, take the Product, proof of purchase and full details of the alleged defect to any Kitchen Warehouse store.

## **Limitations**

We make no express warranties or representations other than as set out in this guarantee. The replacement of the Product or the refund of the purchase price is the absolute limit of our liability under this guarantee.

# KITCHEN PRO

**Distributed by Kitchen Warehouse.**

Kitchen Pro is a registered trademark of Kitchen Warehouse Pty Ltd.

The printed material appearing in this document and related packaging is protected by copyright. Illustrations in this manual are for reference only and may differ from the actual product.

**Kitchen Warehouse Pty Ltd**

1 Pensioner Guard Road

North Fremantle, WA, 6159

[www.kitchenwarehouse.com.au](http://www.kitchenwarehouse.com.au)

1800 332 934

[customerservice@kitchenwarehouse.com.au](mailto:customerservice@kitchenwarehouse.com.au)