

KITCHEN PRO



PREP Pull Chopper

IMPORTANT

Read and follow all warnings and instructions before assembly and use.
Keep this manual for future reference.

Specifications

- Model number: 722994
- Dimensions: 14.8x11.8x11.8cm / 900mL
- Material: ABS, PP, PS, TPE, stainless steel

Product features

The Kitchen Pro Prep Pull Chopper is a manual mini food processor designed for quick and efficient chopping, mixing, and blending. With a simple pull-cord mechanism, it delivers controlled results while saving time and effort in the kitchen.

- Manual pull-cord operation, no electricity required
- Stainless steel chopping blade for efficient cutting
- Beater paddles for mixing, blending, and pureeing
- Sweeper arm helps prevent food from sticking to the bowl
- 900mL transparent chopping bowl
- Collapsible handle for compact storage
- Non-slip base for added stability during use

Safety precautions

- Keep away from high heat.
- Do not use this product in an oven or microwave oven.
- The blades are extremely sharp. Handle with care.
- Keep out of reach of children.

Get to know the Kitchen Pro Prep Pull Chopper

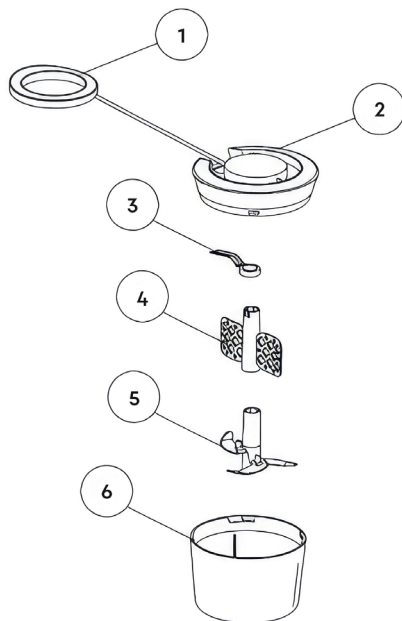

Product components

1. Pull handle
2. Chopper lid
3. Sweeper arm
4. Beater paddles
5. Blade holder with chopping blade
6. Chopping bowl with non-slip base

Operating instructions

How to use the beater paddles

1. Insert the beater paddles onto the base of the bowl, ensuring they are positioned in the lower part of the bowl.
2. Add ingredients to the bowl. Do not fill more than half of the bowl capacity.
3. Place the lid on the bowl. Ensure the beater connects correctly and lock the lid in place by engaging the tabs and turning it slightly clockwise.
4. Hold the bowl firmly on the worktop with one hand. Pull the handle on the lid with the other hand to begin mixing or beating.

How to use the chopping blade

1. Fit the sweeper arm onto the blade holder.



2. Place the blade assembly into the center of the bowl.



3. Add prepared ingredients into the bowl.



4. Place the lid on top of the bowl:

- Align the spindle on the lid with the hole in the blade holder.
- Turn the lid clockwise to secure it.



5. Hold the bowl firmly with one hand. Pull the handle outwards and away from the bowl to activate the chopping action.

- The pull cord will automatically retract after each pull.
- Do not pull the cord fully out.



6. Repeat pulling until the desired chopping consistency is achieved.



Important notes

- Do not place whole vegetables directly into the chopper. Cut ingredients into large chunks before chopping.
- Do not overfill the bowl beyond 1/2 of its total capacity.

Cleaning and maintenance

- The bowl, blade assembly, and beater paddles are dishwasher safe (top rack only).
- Do not attempt to dry the blade by hand. Allow it to air dry to avoid injury.
- The lid should be wiped clean only.
- Do not immerse the lid in water, as prolonged exposure to moisture may damage the internal pull cord mechanism.

Get in touch with Customer Service

If you experience any issues with your Kitchen Pro Prep Pull Chopper, get in touch with our Customer Service team by email at customerservice@kitchenwarehouse.com.au or by phone on 1800 332 934 between the hours of 9am and 7pm (AEST) Monday to Friday.

Warranty

Our goods come with guarantees that cannot be excluded under the Australian Consumer Law. You are entitled to a replacement or refund for a major failure and for compensation for any other reasonably foreseeable loss or damage. You are also entitled to have the goods repaired or replaced if the goods fail to be of acceptable quality and the failure does not amount to a major failure.

The benefits of this warranty are in addition to any rights and remedies imposed by Australian State and Federal legislation that cannot be excluded. Nothing in this warranty excludes, restricts or modifies any State or Federal legislation applicable to the supply of goods which cannot be so excluded, restricted or modified.

Guarantee

We warrant that, subject to the exclusions and limitations below, the Product will be free from defects in materials and workmanship under normal domestic household use for the five year warranty period. The warranty period commences on the date of sale by the original retailer to the original purchaser. The warranty applies only while the Product is owned by the original purchaser.

Use of the Product in a commercial capacity will void this warranty. If a defect appears in the Product before the end of the warranty period and we find the Product to be defective in materials or workmanship, we will replace the Product with a product comparable in quality and value.

We reserve the right to change or discontinue our product ranges at any time without notice and without liability.

Exclusions

This warranty does not apply if proper care and/or usage instructions are not followed. This warranty does not cover scratches, stains, discoloration or damage caused by misuse.

How to claim

If a fault/defect is identified cease using the Product immediately. To make a claim on this guarantee, take the Product, proof of purchase and full details of the alleged defect to any Kitchen Warehouse store.

Limitations

We make no express warranties or representations other than as set out in this guarantee. The replacement of the Product or the refund of the purchase price is the absolute limit of our liability under this guarantee.

KITCHEN PRO

Distributed by Kitchen Warehouse.

Kitchen Pro is a registered trademark of Kitchen Warehouse Pty Ltd.

The printed material appearing in this document and related packaging is protected by copyright. Illustrations in this manual are for reference only and may differ from the actual product.

Kitchen Warehouse Pty Ltd

1 Pensioner Guard Road

North Fremantle, WA, 6159

www.kitchenwarehouse.com.au

1800 332 934

customerservice@kitchenwarehouse.com.au